

Care and Maintenance

CAUTION



Do not touch the area around the printing carriage with hand.

Failure to do so may result in burns.

NOTICE Be sure to switch off the main power for the PC-60 before attempting to clean the unit and platen or using head cleaner to clean the printing head.

Never attempt to oil or lubricate the mechanism.

Cleaning the printing head

The PC-60 automatically performs cleaning of the printing head.

The head is cleaned with the cleaning pad on the front-left surface of the unit when an ink-ribbon cartridge is replaced. Ordinary grime is removed by this automatic cleaning, but when soiling is severe, the head cleaner included with the unit should be used to remove it.

The method described below is used to perform cleaning with the head cleaner.

NOTICE Drops of cleaning fluid may spray out when the cap is opened. Hold away from the platen when opening the cap. The platen may be discolored by any cleaning fluid that comes in contact with it. (The cleaning fluid is non-toxic.)

Use the included head cleaner to remove grime from the printing head.

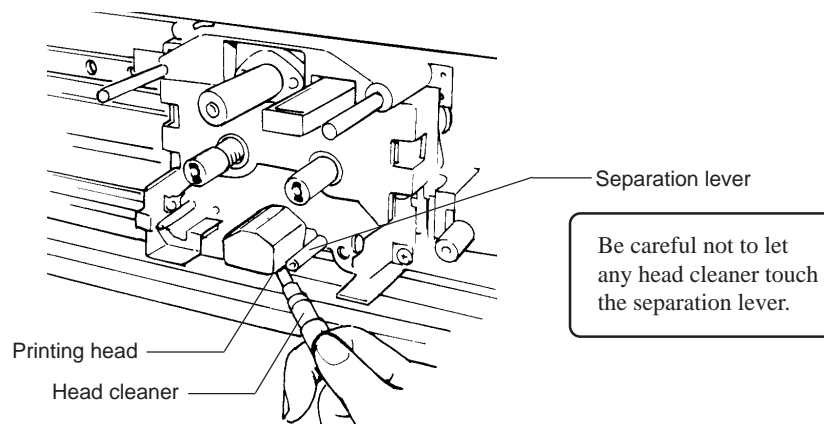

Cleaning the main unit

For routine cleaning, use a soft piece of cloth.

Cleaning the platen

If the platen becomes soiled, wipe it clean with a dry, soft cloth.

Do not wipe with a head cleaner or alcohol.

Use care when cleaning to avoid damaging the surface of the platen. Printing quality may suffer.

The Cleaning Pad

If the cleaning pad on the left edge of the unit's front surface is damaged, the printing head may be destroyed.

If the cleaning pad is damaged by a blade or the like, replace it with a new cleaning pad.

Continuing to use a cleaning pad that has deteriorated may impair printing quality.

As a general guideline, the cleaning pad should be replaced with a new one after printing about 50 m of material (24" in width).

Self-test

The PC-60 is equipped with a “self-test” function to allow you to check whether or not it is capable of operating normally. If the PC-60 is not performing correctly, follow the steps below to perform a self-test.

A computer is not required in order to carry out the self-test.

1 Leave on the main power for the PC-60, and switch off the sub power.

2 Install blade holders and four-color (CMYK) ribbon cartridges on the PC-60.

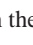
3 Hold down the  key on the panel while you turn the  key (sub power) on.

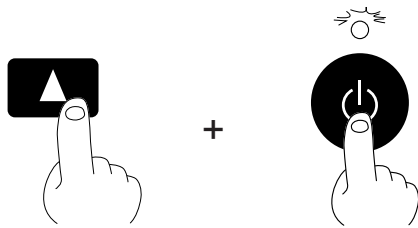

4 Load material and lower the sheet loading lever.

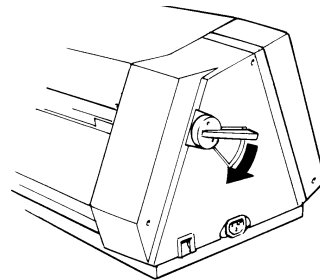

5 Gently close the front cover.

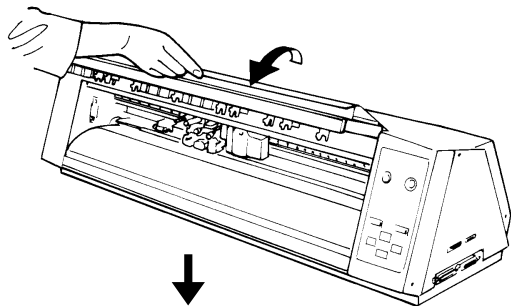

Self-test starts.

6 Operations is normal if the figure shown at below.

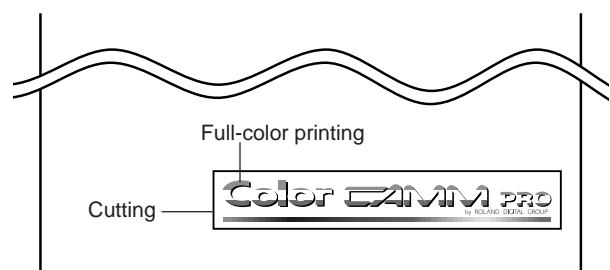

After the operation check has finished, raising the sheet loading lever cancels the operation check mode. After that, the unit operates as it does when the power has been switched on in the normal manner.