

How to Unpack the LPX-250

The packings will be needed if you must repackagethe product. Please do not throw them away.

How to Repack the LPX-250

Repack the machine in the reverse order of this procedure.

1 Take the unit out of the carton.

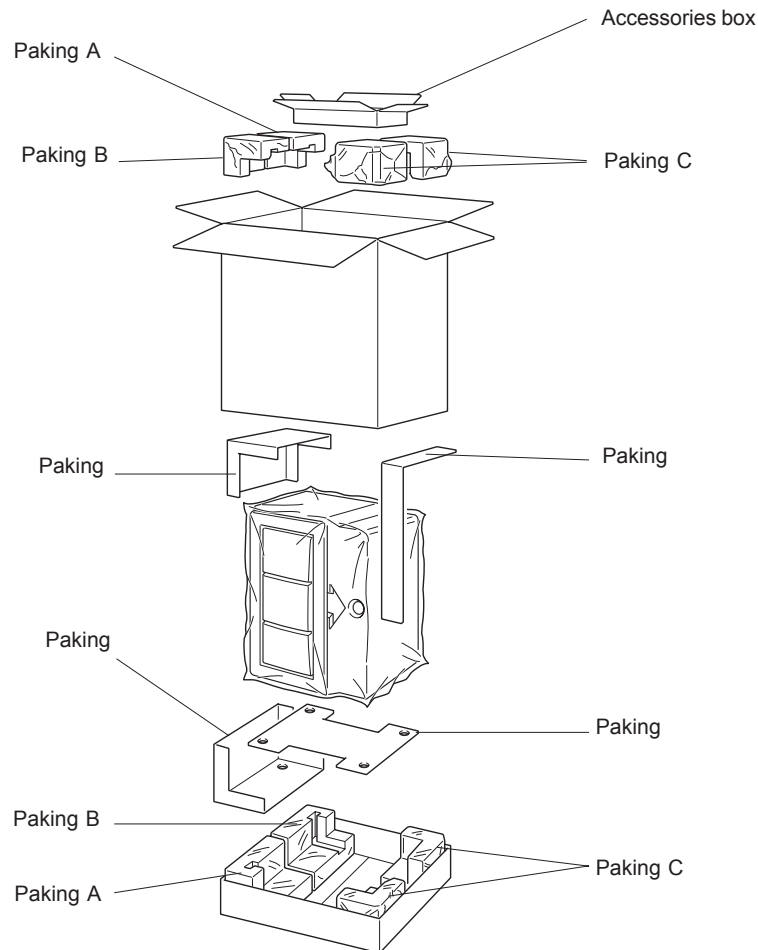

⚠ CAUTION

Unpacking, installation, and moving be carried out by two or more persons. Failure to do so may result in falling of the unit, leading to injury.

NOTICE

Be sure to remove the head retainers before use. Failure to remove them may not only impede operation, but may cause breakdown. Do not attempt to touch any internal area other than the items described below, or to use excessive force to move any item. Doing so may result in breakdown.

2 Using the included hexagonal wrench, detach the retainers.

1

Hexagonal wrench 3 mm

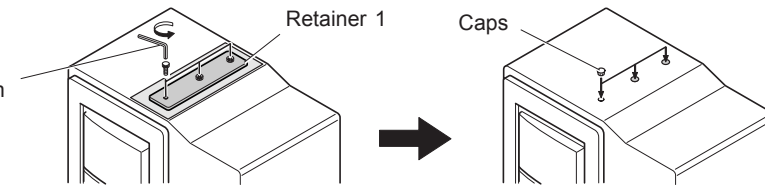

1. Use the hexagonal wrench (3 mm) to remove the three screws, then detach head retainer 1.

2. Attach the three included caps.

2

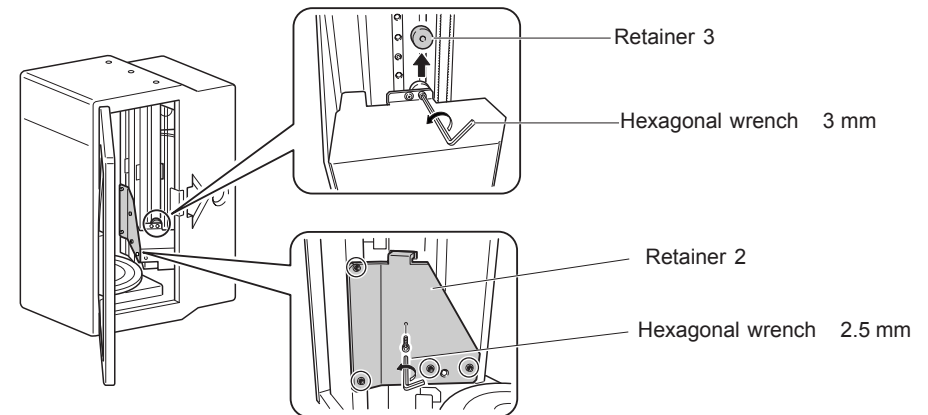

1. Use the hexagonal wrench (2.5 mm) to remove the five screws, then detach head retainer 2.

2. Use the hexagonal wrench (3 mm) to remove one screw, then pull head retainer 3 up and out to extract it. Take care not to drop the retainer when extracting it.